

## Specification for 110-Inch Smart Board



### Features:

- Equipped with Android 11.0 smart operating system and unique 4K UI design interface.
- The system supports high-definition TV processing, providing 4K output with vibrant, clear, and smooth visuals. It also features automatic motion image optimization to reduce image shake.
- Powered by an 8-core 64-bit high-performance CPU (Quad-core ARM Cortex-A73×4 + Quad-core ARM Cortex-A53×4) with a maximum clock speed of 2.28GHz.
- Front removable high-precision infrared touch frame, with touch accuracy of  $\pm 1\text{mm}$ , touch height of 1.0mm, and supports 20-point touch.
- AG anti-glare explosion-proof tempered glass with Mohs hardness of 7, ensuring safety and durability.
- Intelligent light-sensing eye protection mode, automatically adjusting screen brightness based on ambient light.
- Smart temperature control with real-time monitoring of the device temperature, temperature warning, and high-temperature shutdown protection.
- Customizable boot screen, theme, and background. Local media player supports automatic categorization to suit different occasions.
- Wireless screen sharing, supports 4-way and multi-way mirroring, video, music, and document sharing.
- 4K whiteboard with fine writing resolution, simulating calligraphy-like strokes.
- High-performance writing software supporting single-point and multi-point writing, dual pen writing, infinite color palette, image insertion, smart tables, graphics, split-screen, page adding, writing and erasing simultaneously, finger erasing, group discussions, and tools like rulers, protractors, and compasses.
- One-click smart split-screen for documents, apps, and whiteboard operations.

- Hardware self-test without a PC; checks network, RTC, temperature, light sensor, touch, memory, OPS, and more, providing alerts for any anomalies.
- Front full-function Type-C interface for multi-functional expansion, supporting video transmission, USB pass-through, touch pass-through, and 65W power supply for easy and efficient device connection during meetings.
- Lightning protection at level 4, ensuring normal use even during thunderstorms.

## TECHNICAL SPECIFICATIONS :

Display Specifications	
Screen Size	110"
Light Source	WLED
Backlight Type	DLED
Aspect Ratio	16:9
Native Resolution	3840(RGB)×2160, UHD
Frame Rate	60Hz
Brightness	450cd/m <sup>2</sup> (Typ.)
Contrast Ratio	1200:1(Typ.)
Viewing Angle	178°
Display Area	2436.48 mm×1370.52mm(H×V)
Touch Specifications	
Touch Technology	Infrared Touch Frame
Touch Points	20

Glass Specification	AG+AF 4mm Tempered Glass
Response Speed	≤6ms
Touch Accuracy	±1mm (90% Center Area), ±3mm (10% Edge Area)
Touch Diameter	≥3mm
Input Method	Finger or Stylus
Theoretical Click Count	Unlimited
Interface Type	USB 2.0 Full Speed
Operating Voltage	4.75 ~ 5.25V
Power Consumption	≤2 W
System Configuration	
Chip	Amlogic 311D2
System Version	Android 11.0
CPU Architecture	Quad-core ARM Cortex-A73×4 + Quad-core ARM Cortex-A53×4
CPU Clock Speed	2.28GHz
CPU Cores	8 Cores
GPU	Mali-G52 MP2(6EE)×8
RAM	4 GB DDR4
ROM	32GB Standard

Microphone	
Microphone Type	Linear Equidistant Array Microphone
Number of Digital Mics	8
SNR (Signal-to-Noise Ratio)	74dB
Sensitivity	-26±3db
Pickup Distance	10 meters
Sampling Rate	16KHz/24KHz/48KHz (Full Duplex)
Bit Depth	16bit/48bit
Supported Features	Echo Cancellation, Beamforming, Environmental Noise Reduction, Adaptive Voice Enhancement
Number of Pickup Boards	2
Camera	
Image Sensor	1/2.0
Pixel Size	0.8x0.8um
SNR	TBD dB
Dynamic Range	TBD dB
Minimum Illumination	0.1Lux at F12
Aperture	1.8
Filter	650±10nm

Focal Length	5.25mm
Field of View	120° (Optional), Wide Angle Distortion ≤1.5%
Video Format	YUV / MJPG
Resolution Support	800x600(30fps), 1280x720(30fps), 1920x1080(30fps), 2048x1536(30fps), 2592x1944(30fps), 3840x2160(30fps), 4000x3000(30fps), 8000x6000(5fps)
Focus Method	Fixed Focus
Focus Speed	N/A
Interfaces	
Network	RJ45 10/100/1000Mbps× 2
HDMI IN (2.0)	×2
VGA IN	×1
DP IN	×1
TYPE-C	×1 (Full Function 65W Power Supply)
PC AUDIO IN	×1
HDMI OUT (2.0)	×1
LINE OUT	×1
COAX OUT	×1
RS-232	×1
Touch USB	USB3.0 Type-B×2
USB 3.0	USB3.0 Type-A×2 (Shared)

USB 2.0	USB2.0 Type-A×1
WIFI Antennas	4 (2.4/5G Hotspot×2, 2.4/5G WIFI×1, Bluetooth ×1 (5.0)×2)
TYPE-C	×1 (Full Function 65W Power Supply)
Touch USB	Touch Type-B×1
HDMI 2.0 IN	×1
Three-in-One Switch	×1
OPS	80-pin JAE Connector 42mm
Magnetic Pen Slots	×2

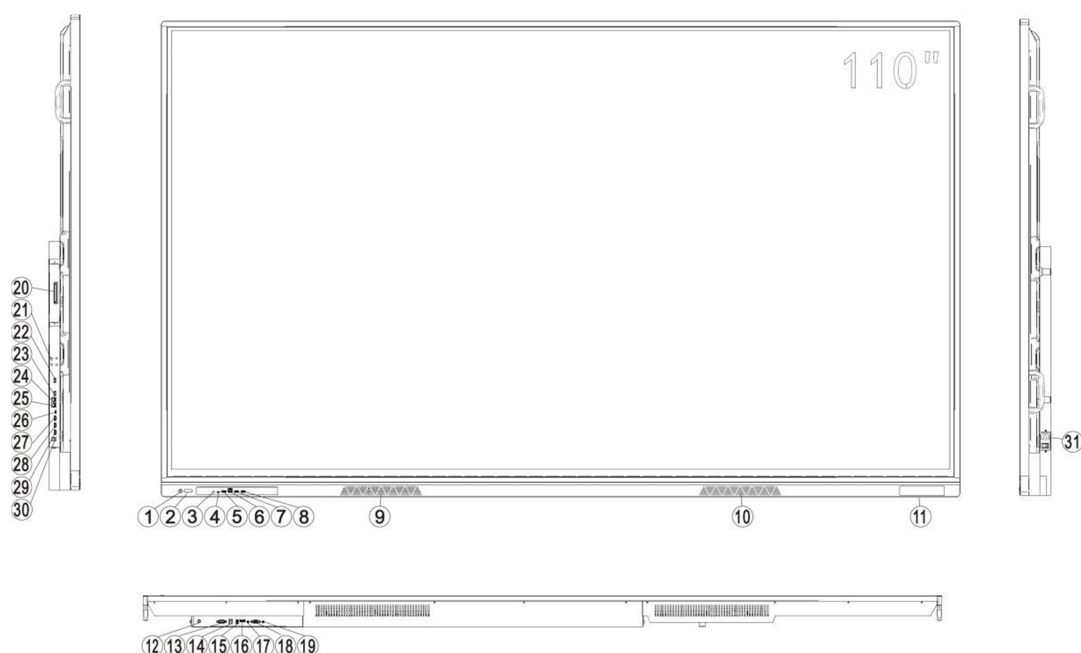

1	Power button blue light: On – Power; Off – Standby/Off	17	VGA Audio IN
2	Remote control indicator (Red: Standby/Off)	18	VGA IN
3	Light sensor	19	LINE OUT
4<	Front TY PC-C (Full-function 65W)	20	OPS Port
5	Front HDMI 2.0	21	5GHz/Bluetooth antenna
6	Front TOUCH 2.0	22	USB 3.0 (Shared)
7	Front USB 3.0 (Shared)	23	USB 3.0 (Shared)
8	Front USB 3.0 (Shared)	24	10/100/1000Mbps Ethernet Port
9	Speaker (Top area for magnetic pen slot)	25	10/100/1000Mbps Ethernet Port
10	Speaker (Top area for magnetic pen slot)	26	USB-C (Full-function TY PC-C 65W)
11	~	27	HDMI OUT
12<	COAX OUT	28	HDM IN1
13<	RS-232	29	HDM IN2
14	TOUCH 3.0(HDM IN1,HDM IN2)	30	TOUCH 3.0(HDM IN1,HDM IN2)
15	USB 2.0(Android)	31	AC socket + Switch
16	DP IN		

Sound	
Audio Power	8Ω/20W*2
Power Supply	
Power Supply	AC100-240V 50/60Hz
Max Power Consumption	720W
Standby Power Consumption	0.5W
Operating Environment	0°C ~ 50°C
Temperature	0°C ~ 50°C
Humidity	10 ~ 90%, Non-condensing
Appearance	
Enclosure Material (Front/Back)	Aluminum Alloy/Sheet Metal
Enclosure Color (Front/Back)	Black/Iron Gray

VESA Mount	1000 mm×(400 mm + 400 mm) 6-M8 screw holes
Dimensions & Weight	
Overall Dimensions (W×H×D)	2501.2 mm×1513.98 mm×97.15 mm / 128.5 mm (Including Wall Mount)
Packaging Dimensions (W×H×D)	2635 mm×1635 mm×300 mm
Net Weight/Gross Weight	113.75 kg / 143 kg
Accessories	
Wifi Antennas	4
Magnetic Writing Pen	1
Remote Control	1
User Manual	1
Certificate/Warranty Card	1
2-meter Power Cable	1
Wall Mount Kit (Including Screws)	1 set
Screen Mirroring Device	(Optional)
Smart Pen	(Optional)



DRAWING :

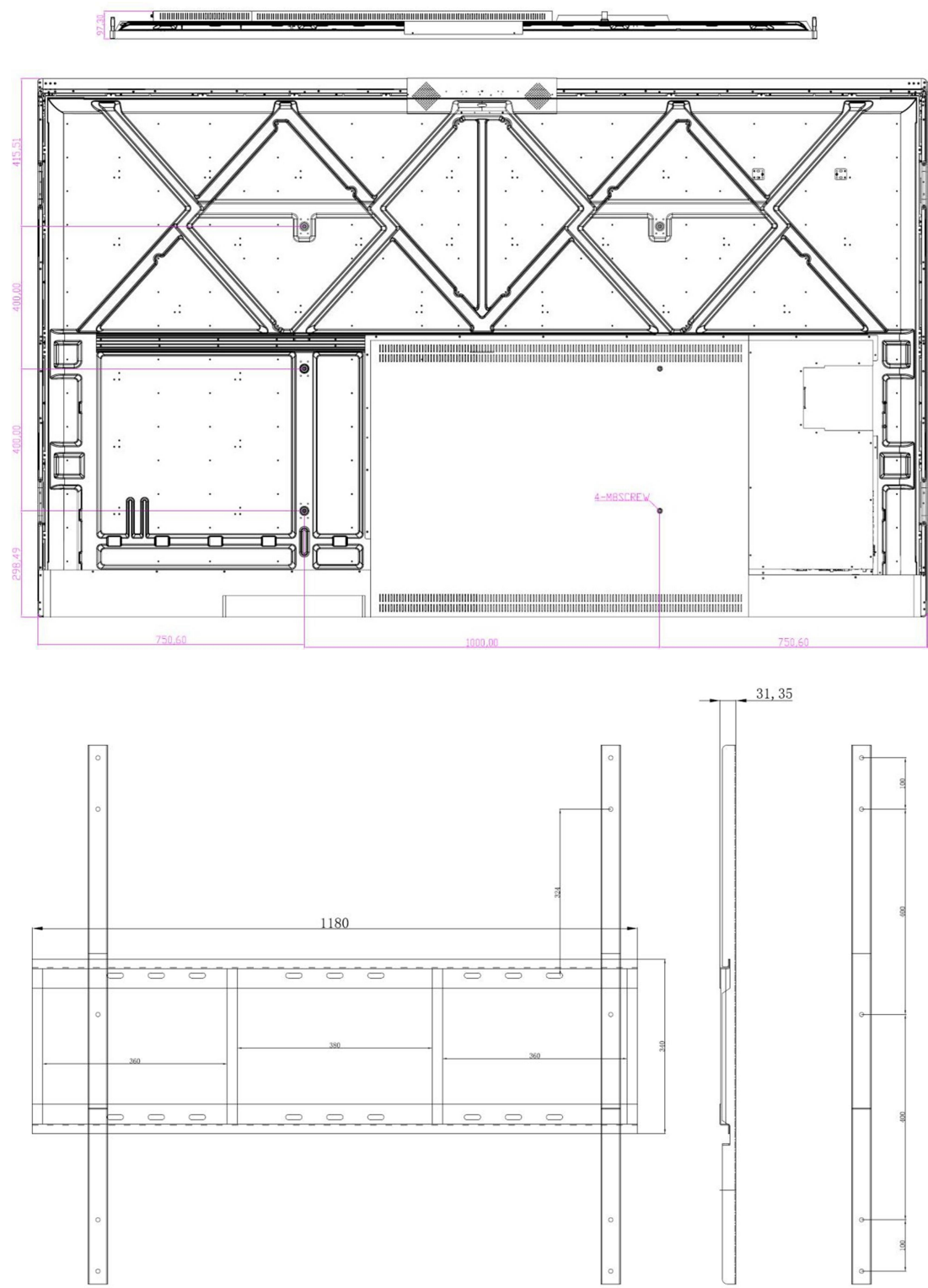

## PRODUCT PHOTOS :

